

Compashield® splice quality requirements:

No reduction of the shielding properties in the splicing area. Splicing rubber thin and conductive.
No flash, porosity or excess rubber at the joint after splicing.
Max increase of compression force in the splicing area 5%. No excess splicing rubber inside hollow profiles.
Joining point should stand for 10% stretch without mechanical damage

Cross-section area

3.15 mm²

Electrial resistance measure:

Methode: Nolato R3 Max: 150 mOhm

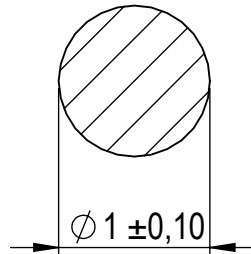

Nolato Silikonteknik

Art.nr	Material	Length	Weight/m	Splice
1240300	8605	Roll	2.8g	No

REVISIONS		
REV.	DATE	DESCRIPTION

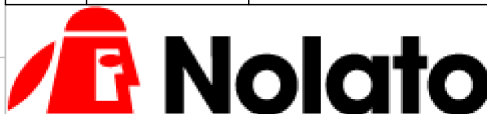

Document name
CompaShield Solid O-shape

	Sheet scale 20:1	Sheet size A4	Document no. P2403:15:001	Rev no. A	Nolato art. no. 1240300
--	----------------------------	-------------------------	-------------------------------------	---------------------	-----------------------------------

General tolerances	Drawn by S.M	Checked by O.E	Date 2015-03-05
--------------------	------------------------	--------------------------	---------------------------

SS ISO 3302-1 M3	Reference cad data 1240300 A CompaShield Solid O-shape
------------------	--