

**Compashield® splice quality requirements:**

No reduction of the shielding properties in the splicing area. Splicing rubber thin and conductive.  
No flash, porosity or excess rubber at the joint after splicing.  
Max increase of compression force in the splicing area 5%. No excess splicing rubber inside hollow profiles.  
Joining point should stand for 10% stretch without mechanical damage

Cross-section area

1,38 mm<sup>2</sup>

**Electrial resistance measure:**

Methode: Nolato R3 Max:300 mOhm

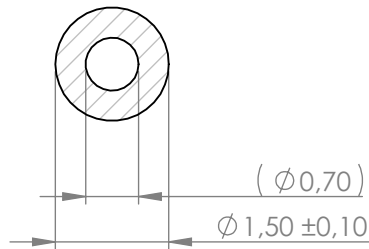

Art.nr	Material	Lenght	Weight/m	Splice
1212700	8642	Roll	3,4 g	No
1212701		140 ± 2 mm		Yes
1212702		301 ± 2 mm		Yes
1212703		146 ± 2 mm		Yes
1212704		80 ± 2 mm		Yes

REVISIONS		
REV.	DATE	DESCRIPTION
A	131015	New drawing. //PÅ

		Document name <b>Compashield Hollow O-shape</b>		
	Sheet scale 10:1	Sheet size A4	Document no. P2127:13:001	Rev no. F
General tolerances  ISO 3302-1 M3		Drawn by P. Åkerberg	Checked by P.Brock	Nolato art. no. 1212700
		Reference cad data		Customer no.
		Date 2013-10-15		Part version no.