

Compashield® splice quality requirements:

No reduction of the shielding properties in the splicing area. Splicing rubber thin and conductive.
 No flash, porosity or excess rubber at the joint after splicing.
 Max increase of compression force in the splicing area 5%. No excess splicing rubber inside hollow profiles.
 Joining point should stand for 10% stretch without mechanical damage

Cross-section area1,54 mm²**Electrial resistance measure:**

Methode: Nolato R3 Max: N/A

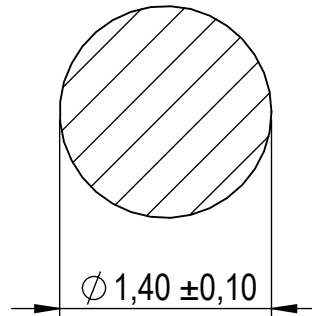

Art.nr	Material	Length	Weight/m	Splice
1277000	1540	Roll	1,7g	No
1277001		724 ±5 mm		Yes
1277002		457 ±4 mm		Yes
1277003		143 ±3 mm		Yes
1277004		249 ±3 mm		Yes
1277005		606 ±5 mm		Yes
1277006		292 ±3 mm		Yes
1277008		716 ±5 mm		Yes

REVISIONS

REV.	DATE	DESCRIPTION

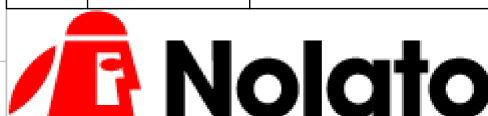

Document name

Solid O-shape

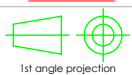

1st angle projection

Sheet scale
20:1Sheet size
A4Document no.
P2770:16:001Rev no.
DNolato art. no.
1277000

General tolerances

Drawn by
OEChecked by
J.BDate
2015-11-28

SS ISO 3302-1 M3

Reference cad data

1277000 D Solid O-shape