

Compashield® splice quality requirements:

No reduction of the shielding properties in the splicing area. Splicing rubber thin and conductive.

No flash, porosity or excess rubber at the joint after splicing.

Max increase of compression force in the splicing area 5%. No excess splicing rubber inside hollow profiles.

Joining point should stand for 10% stretch without mechanical damage

Cross-section area**11,75 mm²****Electrial resistance measure:**

Method: Nolato R3 Max: 300 mOhm

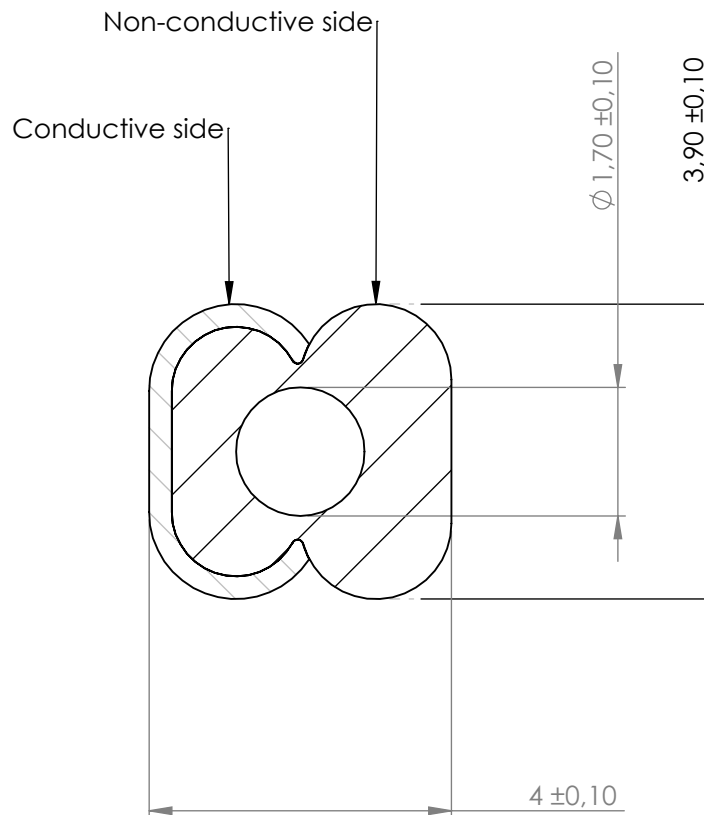

Art.nr	Material	Lenght	Weight/m	Splice
1195200	8648 /1540	Roll	5g / 11g	No
1195201		1522 ± 5 mm		Yes
1195202		1250 ± 5 mm		Yes
1195203		964 ± 5 mm		Yes
1195204		116 ± 3 mm		Yes
1195205		1512 ± 5 mm		Yes
1195206		1035 ± 5 mm		Yes
1195207		1037 ± 5 mm		Yes
1195208		1202 ± 5 mm		Yes
1195209		802 ± 5 mm		Yes
1195210		789 ± 3 mm		Yes
1195211		1436 ± 5 mm		Yes

REVISIONS

REV.	DATE	DESCRIPTION

**Nolato**

Document name

Compashield EE

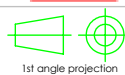

1st angle projection

Sheet scale
1:10Sheet size
A4Document no.
P1952:12:001Rev no.
LNolato art. no.
1195200

Customer no.

General tolerances

Drawn by
S.MuhonenChecked by
P.BrockDate
2012-09-18

ISO 3302-1 Class M3

Reference cad data

Part version no.